

REV.	REVISIONS REC.	DATE
A/1	侧插Pin改为弯Pin	2010.07.09
A/2	(M) 3.00改为3.20	2010.11.11
	(X1) 侧面Pin长2.50	2010.11.11
	(F) 34.00改为33.00	2010.11.11

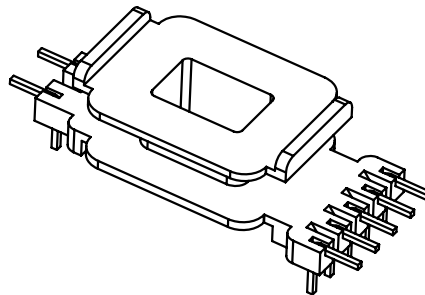

注：“★”为重点尺寸，未注R角为0.3，共B-1667模架

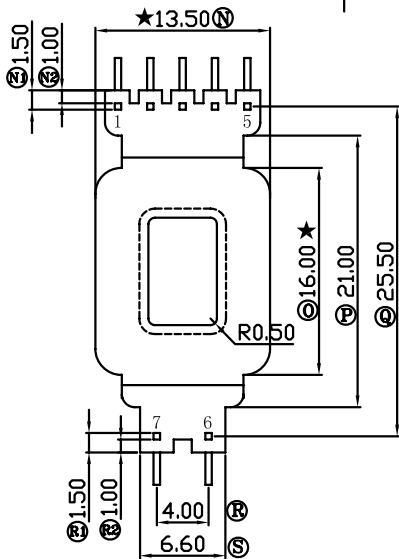
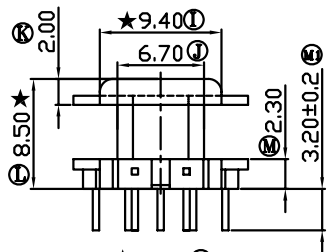
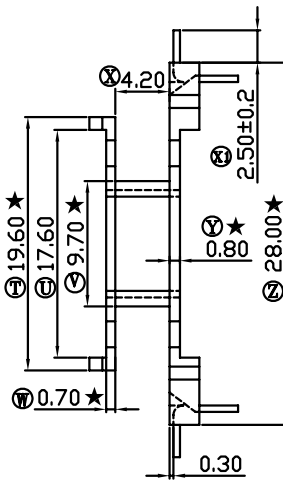
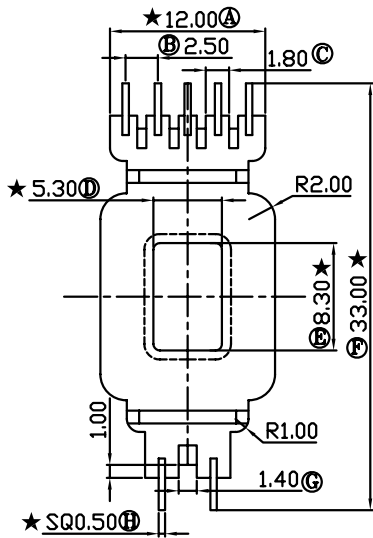

深圳市搏思康电子有限公司
SHENZHEN BOSCOM ELECTRONICS CO.,LTD

ADDRESS	深圳市观澜街道石马径社区君新路 石三工业区146号
TELEPHONE	0755-28032969 28032970 28032971
FAX	0755-28032965

型号 MODEL NAME		产品编号 DRAWING NO	
ED-17 (5+2P)		B-1703	
MATERIAL	PM-9630	PIN MATERIAL	CP WIRE
SCALE	FIT	TOLERANCE	
DRWING	YANG 21/01/2010	0<L<4 ±0.10 4≤L≤16 ±0.20 16以上 ±0.30	
DESIGNEG	邹上峰	壁厚: ±0.10 PIN径: ±0.05	
APPROVED	李德永		