

REV	REVISIONS REC	DATE
A/1	Ⓜ 0.5改到0.6	2013.09.16
	Ⓥ 0.6改到0.7	2013.09.16
	Ⓟ1 0.30改到0.50	2013.09.16
	Ⓞ1 3.2改到3.4	2013.09.16
A/2	Ⓞ 6.2改到6.45	2013.11.15
	Ⓛ1 0.25改到0.5	2013.11.15
	编号与原B-1804-1对调	2013.11.15

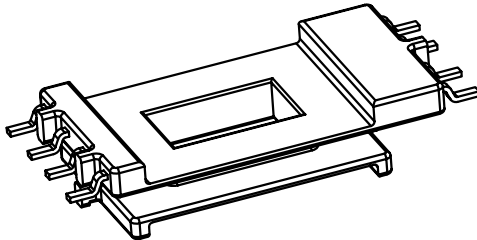
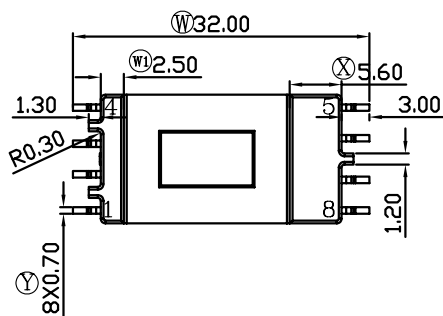
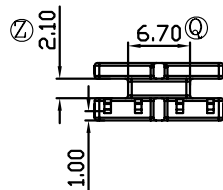
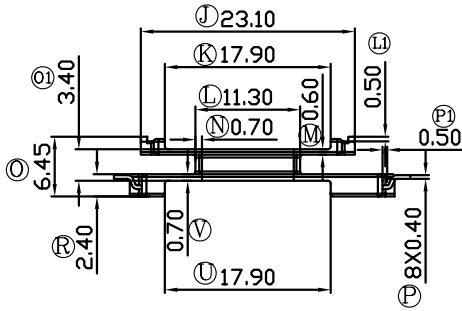
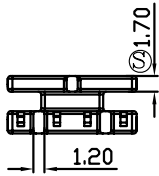
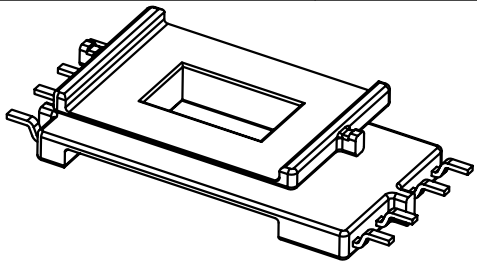
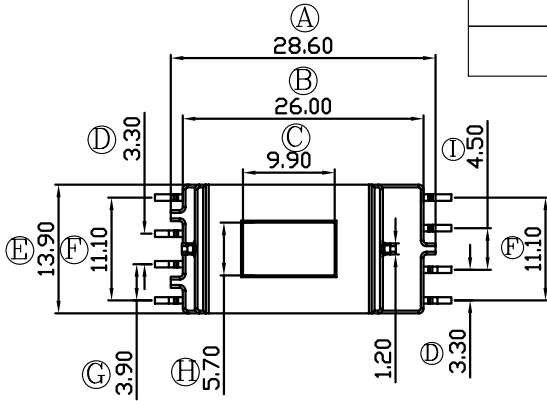

深圳市搏思康电子有限公司  
SHENZHEN BOSCOM ELECTRONICS CO.,LTD

ADDRESS	深圳市观澜街道石马径社区君新路石三工业区146号
TELEPHONE	0755-28032969 28032970 28032971
FAX	0755-28032965

型号 MODEL NAME		产品编号 DRAWING NO	
ED-18 (4+4P)		B-1804	
MATERIAL	PM-9630	PIN MATERIAL	CP WIRE
SCALE	FIT	TOLERANCE	
DRWING	ZHOU 04/07/2013	0<L<4 ±0.10 4≤L≤16 ±0.20 16<L≤63 ±0.30	
DESIGNED	张长青	壁厚: ±0.10 PIN径: ±0.05	
APPROVED	张建华		