

REV	REVISIONS REC	DATE
A/1	(C) 尺寸由3.5改为3.8	2018. 07. 28
	(H) 尺寸由6.0改为6.1	2018. 07. 28

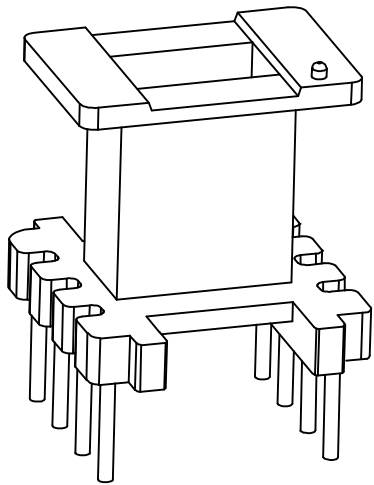

注：“★”为重点尺寸，未注R角为0.3

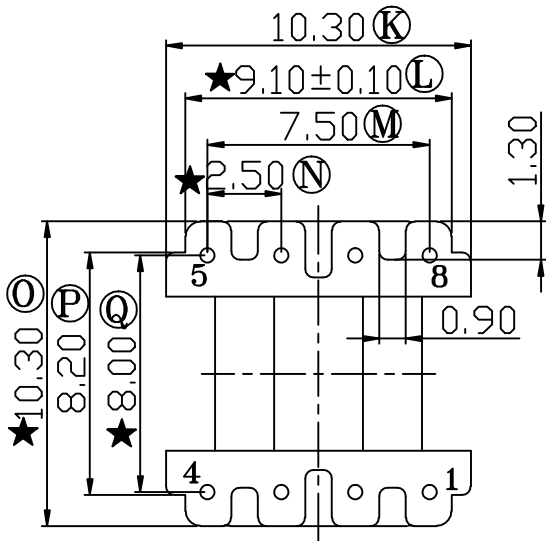
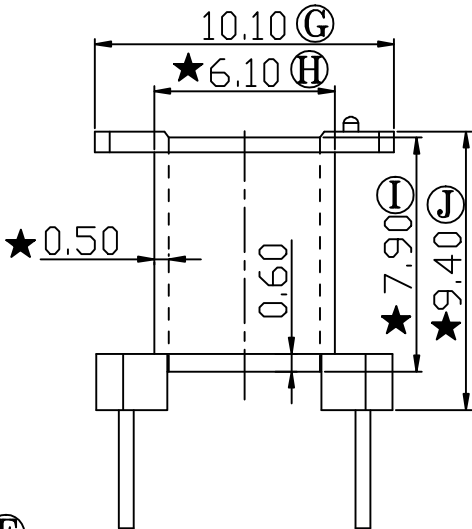
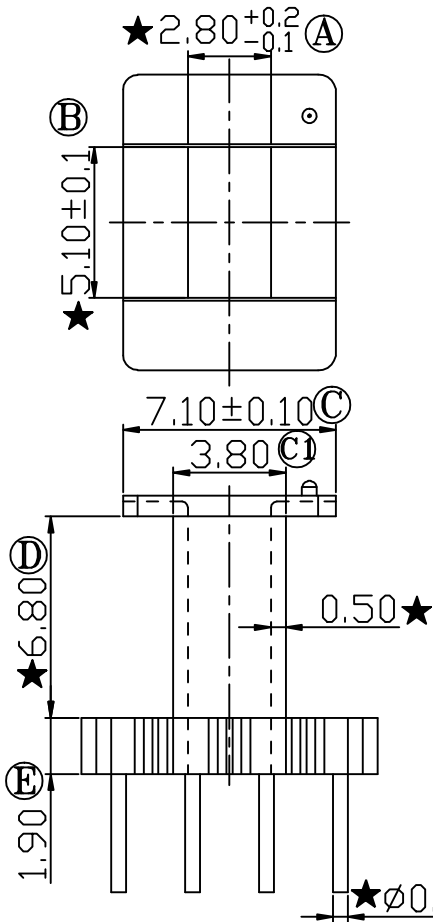

深圳市搏思康电子有限公司  
SHENZHEN BOSCOM ELECTRONICS CO.,LTD

ADDRESS	深圳市观澜街道石马径社区君新路石三工业区146号
TELEPHONE	0755-28032969 28032970 28032971
FAX	0755-28032965

型号 MODEL NAME		产品编号 DRAWING NO	
EI-10 (4+4P)		B-1009	
MATERIAL	PM-9820	PIN MATERIAL	CP WIRE
SCALE	FIT	TOLERANCE	
DRWING	LI 21/10/2009	0<L<4 ±0.10	壁厚: ±0.10 PIN径: ±0.05
DESIGNED	邹上峰	4≤L≤16 ±0.20	
APPROVED	李德永	16以上 ±0.30	