

REV.	REVISIONS REC.	DATE
A/1	① 22.4改到22.7	2009.06.07
A/2	① 加厚0.5mm防挡	2010.01.08
A/3	① 处顶部卡口切斜角	2015.03.30

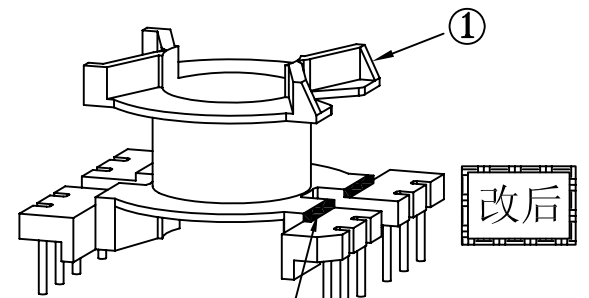

注：“★”为重点尺寸，未注R角为0.3，
共用B-3201后模仁，左右滑块

① 加厚0.5mm防挡

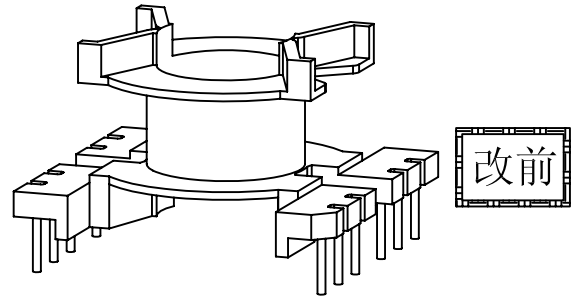
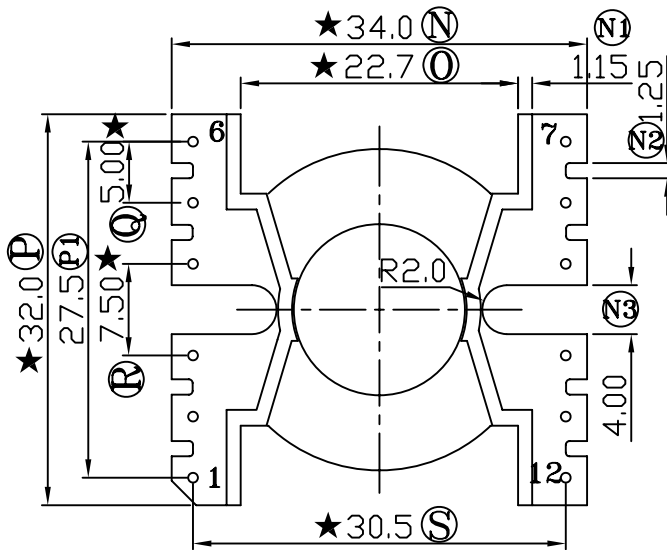
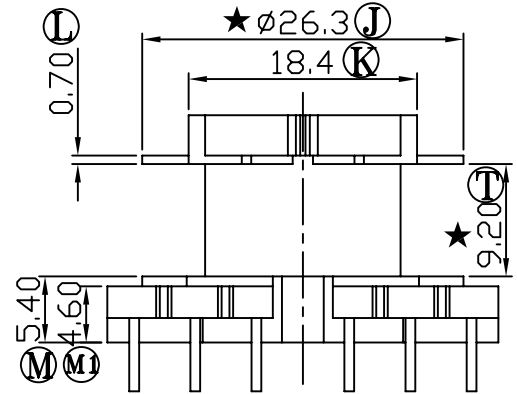
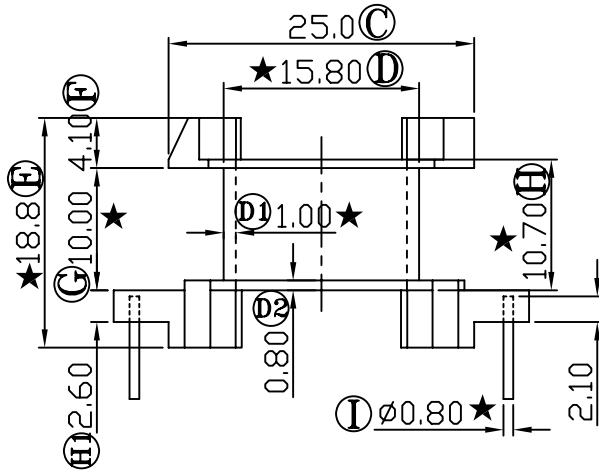
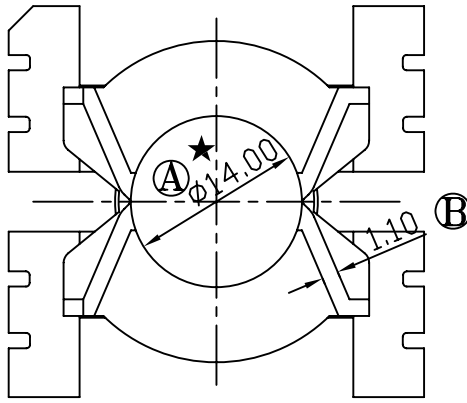

深圳市博思康电子有限公司
SHENZHEN BOSCOM ELECTRONICS CO.,LTD

型号
MODEL NAME

PQ-3220 (6+6P)

产品编号
DRAWING NO

B-3201-3

ADDRESS

深圳市观澜街道石马径社区君新路
石三工业区168号

MATERIAL

PM-9820

PIN MATERIAL:
CP WIRE

符合ROHS/HF要求
符合UL94V-0标准

TELEPHONE

0755-28032969 28032970 28032971

SCALE

FIT

TOLERANCE

DRWING

LI 27/06/09

0<L≤4 ±0.10
4<L≤16 ±0.20 壁厚: ±0.10
16以上 ±0.30 PIN径: ±0.05

FAX

0755-28032965

DESIGNEG

APPROVED