

REV.	REVISIONS REC.	DATE

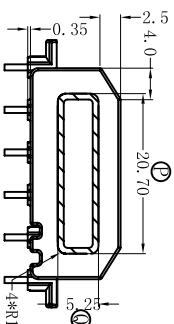

注：  
 1. 焊后拉力：1.5KGMIN  
 2. 强度：1.5KGPMIN  
 3. 耐压：4.0KV/1.5MA  
 1分钟Min  
 4. 焊接温度：450° ±10° 33E

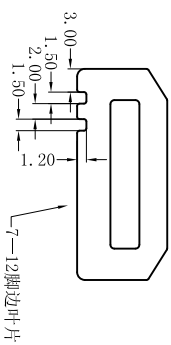
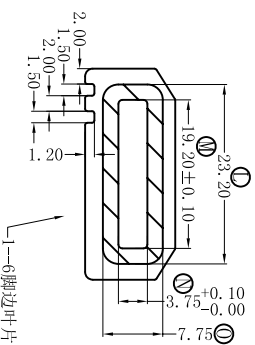
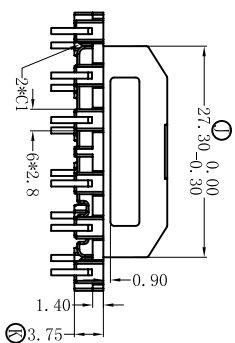
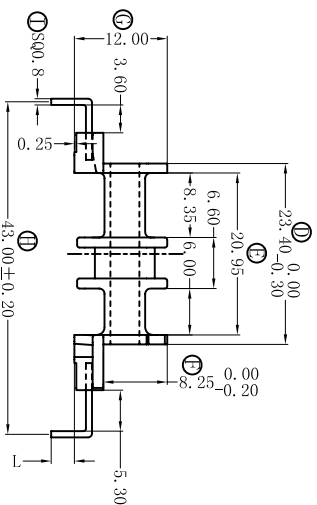
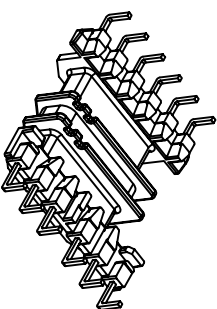
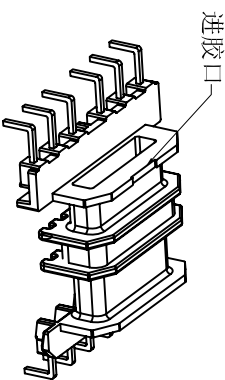
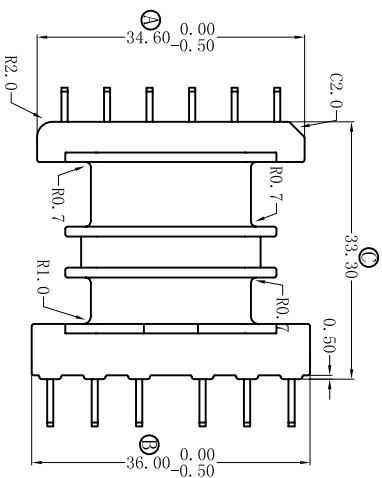
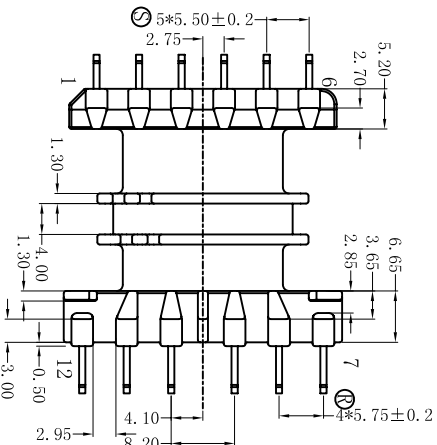

 深圳市博思康电子有限公司 SHENZHEN BOSCOM ELECTRONICS CO.,LTD		型号	EFPD38-(6+6P)		产品编号 DRAWING NO B-3810
		MODEL NAME			
ADDRESS	深圳市观澜街道石马径社区君新路 石三工业区146号				PIN MATERIAL: 符合ROHS/军要求 CP WIRE 符合UL94V-0标准 TOLERANCE
TELEPHONE	0755-28032969 28032970 28032971				
FAX	0755-28032965				1-≤L≤4 ±0.10 4<L≤16 ±0.20 公差: ±0.06 16<L≤30 ±0.30 30<L≤63 ±0.50 PINK: ±0.02
DRWN BY	02/04/2019		DESIGNED	张直洪	
APPROVED			SCALE	FIT	