

REV	REVISIONS REC	DATE
A/1	Ⓜ 0.7改为1.7	17/04/12
	Ⓜ 12.2改为13.2	17/04/12
A/2	Ⓜ 1.7改为1.0	26/04/14
	Ⓜ 13.2改为12.5	26/04/14

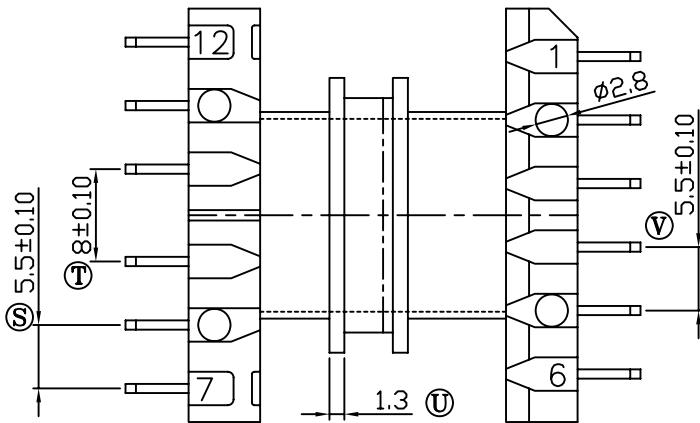

注：“★”为重点尺寸，未注R角为0.3

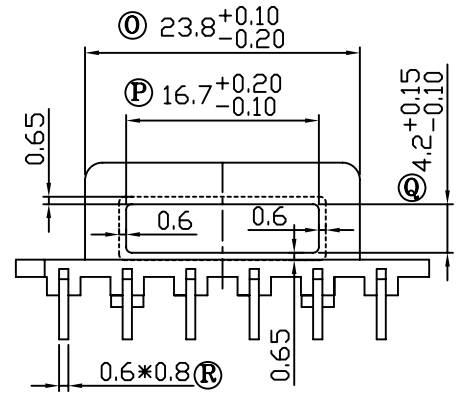
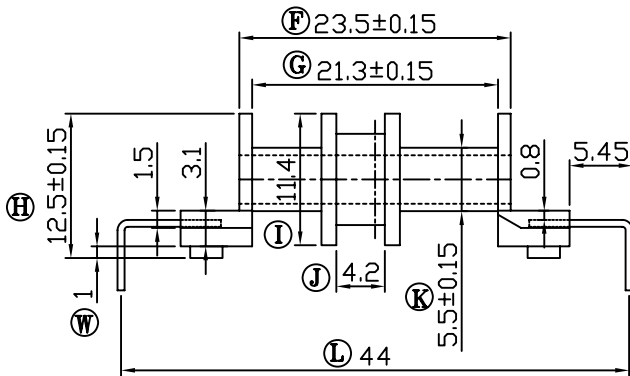
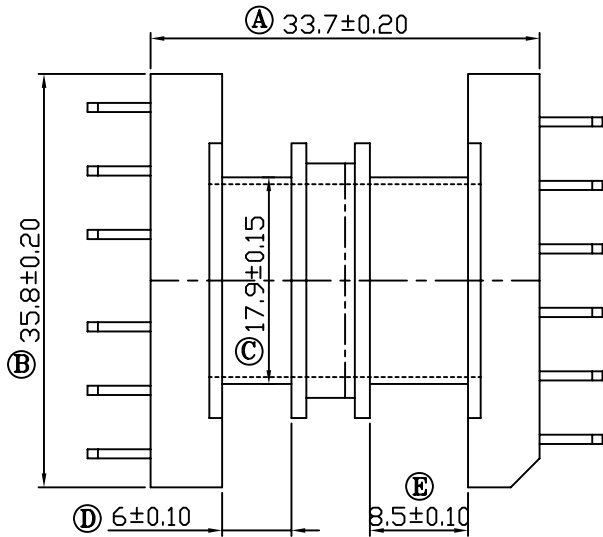

深圳市搏思康电子有限公司  
SHENZHEN BOSCOM ELECTRONICS CO.,LTD

型号  
MODEL NAME

产品编号  
DRAWING NO

EFD-35 (6+6P)

B-M3535-2

ADDRESS

深圳市观澜街道石马径社区君新路石三工业区146号

MATERIAL

PM-9820

PIN

CP WIRE

SCALE

FIT

MATERIAL

TOLERANCE

TELEPHONE

0755-28032969 28032970 28032971

DRWING

LIU 14/02/2012

0<L<4 ±0.10  
4<L≤16 ±0.20 壁厚: ±0.10  
16以上 ±0.30 PIN径: ±0.05

FAX

0755-28032965

DESIGNED

APPROVED